

Information sheet

BPW AirSave

In the drawbar trailer, the reserve pressure for brakes and air suspension should not exceed 8.5 bar. When using single tyres, the air pressure usually has to be higher than the reserve pressure of the vehicle/ drawbar trailer. With tyre pressure control, the tyre pressure is permanently adjusted to a preset level. This means that, with single tyres, the preset pressure required of up to 9.5 bar can be reached accordingly by the so-called booster.

To do this, the air from the trailer air supply is channelled through a safety valve to a control unit, where it is used to achieve the prescribed adjustable tyre pressure by the pressurised-air booster pump. As soon as the pressure drops, it is compensated for by the booster.

Wheel change

BPW AirSave

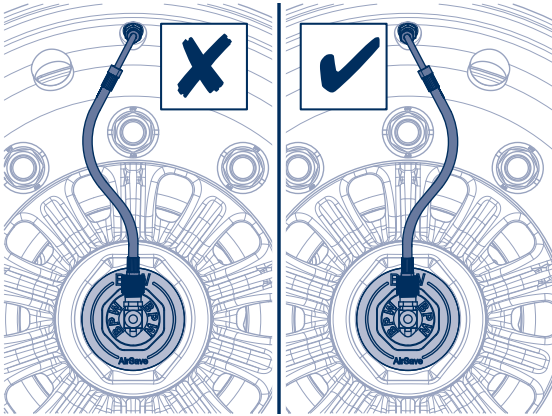

Installation and repair notice

- ✓ When laying the valve hoses, take care to avoid kinks. Wheel nuts must not be covered! Contact with wheel nuts or wheel studs must be avoided to prevent chafing points.

Note: The valve hose must not point in the unscrewing direction of the AirSave rotor.

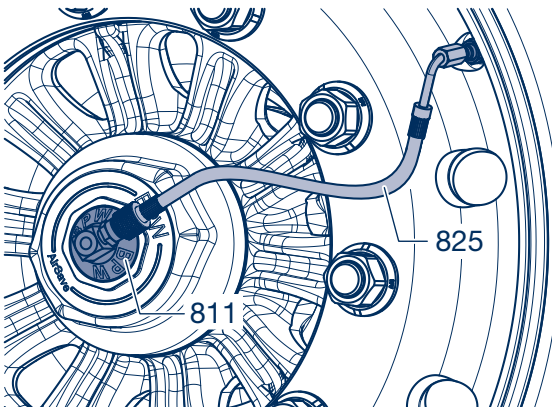

Wheel disassembly

- ✓ [1] Detach the valve hose from the rotor, depending on the tyre.
- ✓ [2] Detach the valve hose from the tyre valve.

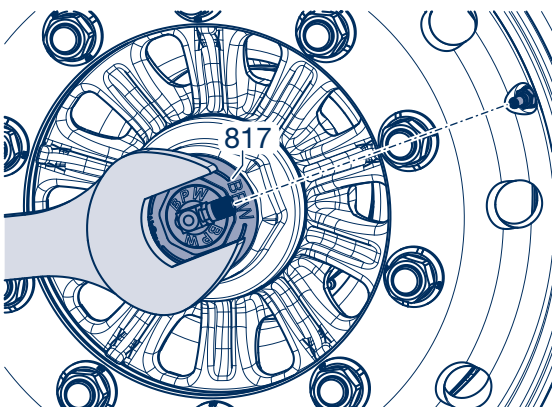

Note

- ✓ For quicker and easier assembly, it is advisable to mark the position of the rim on the wheel hub and recreate this during assembly.

Error messages & diagnosis

BPW AirSave

Condition	Possible causes	Measures
	The system supplies air during commissioning.	The system works faultlessly.
The AirSave LED display is switched on.	The system supplies air to an untight tyre.	Repair the tyre.
	The system supplies air to an untight system component.	Replace the system component.
The AirSave LED display is switched on and air escapes from the rotor.	The system supplies air to an untight system component.	Replace the system component.
	The rotor is untight.	Replace the rotor.
	The stator O-ring is untight.	Replace the stator.
The AirSave LED display is switched off during system operation, although air flows to the AirSave Control Box.	The AirSave LED display is out of operation.	Replace the AirSave LED display.
	The generator is out of operation.	Replace the AirSave Control Box.
	The system cabling is damaged.	Repair the system cabling.
	The system cabling is defective.	Correct the system cabling.
Air escapes from the rotor	The rotor is untight.	Replace the rotor
The tyre pressure is too low.	The shut-off valve is closed.	Open the shut-off valve on the AirSave Control Box
	The pressure setting at the system is too low.	Increase the system pressure at the AirSave Control Box.
The tyre pressure is too high.	The tyre was filled manually with too much pressure.	Reduce the tyre pressure.
	The pressure setting on the system is too high.	Reduce the system pressure at the AirSave Control Box.
The semi-trailer or drawbar trailer deflate when at standstill.	The system tube or the tube/tyre valve connection is untight.	Correctly tighten the connection, replace the seals or replace the tyre valve
	The tube valve is untight.	Clean or replace the valve.
	The tyre is untight.	Repair the tyre.
The tyre fills only slowly or no air flows to the tyre.	The valve hose to the tyre may be tightened too tightly, causing a blockage in the airflow.	Correctly tighten the connection or replace the tube or seal if it is damaged.
Control Box is not functioning	Inlet pressure < 6.0 bar	Check the inlet pressure and adjust if necessary

General information

BPW AirSave



- ❶ Generator, exhaust-operated, self-sufficient power supply
- ❷ Venting of the control unit
- ❸ Connection to LED display or telematics
- ❹ Air connection axles/pressurised-air check during commissioning

Info

- ✓ Self-sufficient system – fully pneumatic
- ✓ Easy tyre pressure adjustment via the test valve outside the box

Spare parts

- ✓ BPW Article-No.: 02.0130.02.30

- ❺ Overpressure relief valve
- ❻ Two-piston compressor Fully pneumatic
- ❼ Adjustment of air pressure



- ❶ Stator
- ❷ AirSave hub cap kit
- ❸ AirSave rotor (rotary transmitter)
- ❹ AirSave hub cap kit

Info

- ✓ BPW rotors are optimised with a PTFE sealing ring
- ✓ New system sealing takes into account the special requirements of BPW wheel bearings
- ✓ Infinitely adjustable hub cap adapter for the tyre valve

Spare parts

- ✓ AirSave hub cap 9 t: 02.801.47.17.0
- ✓ AirSave valve hose ET 120: 02.3510.06.10
- ✓ AirSave valve hose ET 0: 02.3510.05.10
- ✓ AirSave rotor (silver cap): 02.0130.00.30
Version for twin wheels or 10-12 t:
<https://www.bpw.de/airsave>

TYRE PRESSURE CONTROL SYSTEM

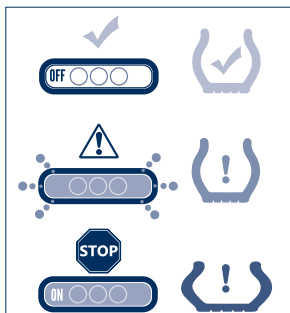

Warning notice for control light

- ✓ AirSave LED display flashes: AirSave is working and equalising the pressure loss in the tyre. There is no need to stop the car.
- ✓ AirSave LED display flashes for longer than 10 minutes: the tyres, compressed-air lines and connections must be checked.
- ✓ AirSave LED display is permanently illuminated: AirSave can no longer equalise the pressure loss in the system or there is a malfunction. A service centre must be sought immediately.

Caren Freudenberg

+49 2262 78 1328 +49 151 291 257 84 FreudenbergC@bpw.de
www.bpw.de

we think transport

