

BPW ECO Drum - Your decisive advantage in the transport business!

BPW Bergische Achsen KG has occupied a leading position in drum brake technology for many years now, and has significantly extended its lead over the competition. Customers have bought more than 11 million drum-brake axles from BPW, and they appreciate the proven technology, robust construction and straightforward maintenance of the BPW drum brake.

In a further development, the proven SN 4218 brake has now been improved again in terms of its weight, wearing properties and ease of service. The result of this development is called ECO Drum. ECO Drum axles contain proven BPW drum brake technology together with a reduction in weight. An optimised design means that the weight of the components for 9 t drum-brake axles has been reduced by about 18 kg per axle with the ECO Drum SN 4218 (see also BPW NEWS Allg. 7125703e). For you, this weight reduction adds up to more payload!



Fig. 1: ECO Drum drum-brake axle with Airlight II air suspension

The most striking feature of the ECO Drum brake is the new drum contour in the bead area as well as a new dust cover design. The newly designed observation holes in the dust covers mean that the wear edges of the brake lining and the brake drum can be checked easily. The improved seal between the dust cover and the brake drum reduces the amount of dirt entering the brake and therefore increases the service life of the brake components. The advantage for the user is obvious. Less complexity and therefore lower costs.



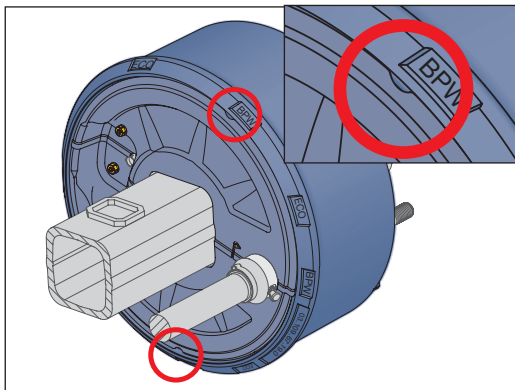

Fig. 2: ECO Drum, lining observation holes

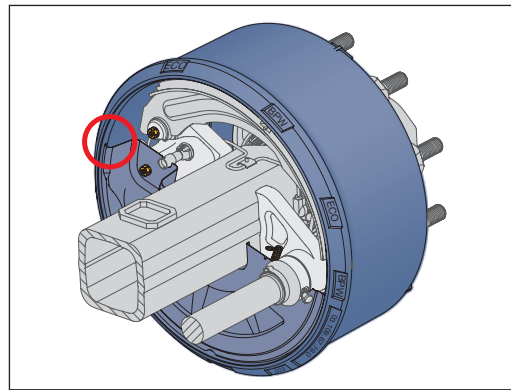
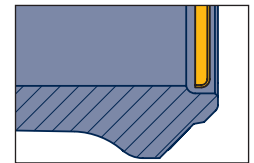

Fig. 3: ECO Drum, dust cover seal



Sectional view:
ECO Drum axle
with new dust cover
contour

The quality of the dust cover attachment has been improved by using threaded bolts. This ensures that the dust cover can still be removed perfectly even after years of operation under the toughest conditions. The dust cover is quickly and easily inserted on the camshaft side and secured by a spring.

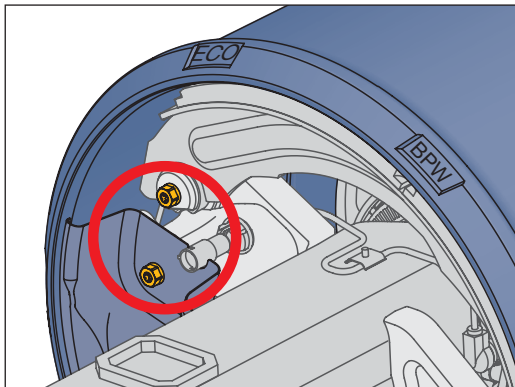

Fig. 4: ECO Drum, threaded bolts

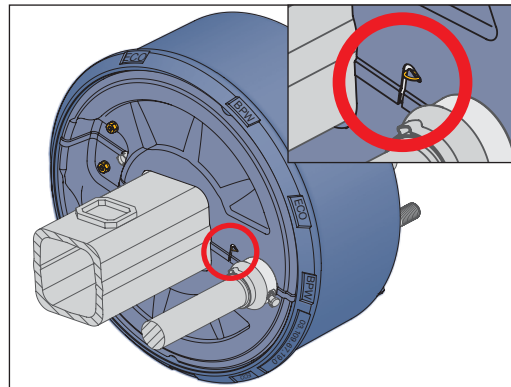

Fig. 5: ECO Drum, spring holder

The advantages of the new ECO Drum are obvious: Greater payload, less wear and even easier servicing. These factors all add up to bigger profits for our customers.

Series launch

The ECO Drum will be available from week 36/2007 onwards. It replaces all existing versions of the SN 4218 (except for axles with a 150 sq. axle beam).

Brake certificate

No new homologations are required for ECO Drum. The updated brake certificates for the ECO Drum SN 4218 can be found in the download centre on the BPW website at www.bpw.de using the familiar TDB numbers. The BPW ECO Drum axle can be installed in a vehicle together with the former drum-brake axle.

Spare parts - compatibility

Only the new ECO Drum brake drums and the new brake shoes will be available as spares. The new brake drums and the new brake shoes can be used on the former drum-brake axles without exchanging the dust cover.

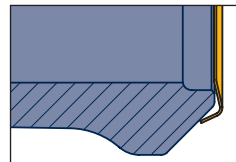
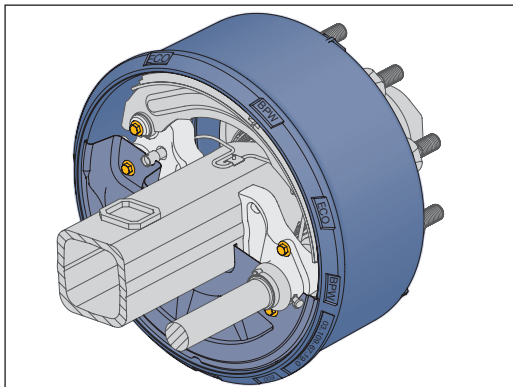

Sectional view:
Former ECO^{Plus} axle
with dust cover and
new ECO Drum

Fig. 6: Former ECO^{Plus} axle with ECO Drum brake drum and ECO Drum brake shoes.

In addition, dust covers are available with the new external contour and the old brake anchor plate attachment. This means customers can benefit from the improved seal integrity between the new dust cover and brake drum design even when using the old type of drum-brake axles.

Conversely, the former brake drums and the former brake shoes can also be used on the new ECO Drum drum brake axles without exchanging the dust cover.

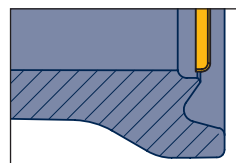
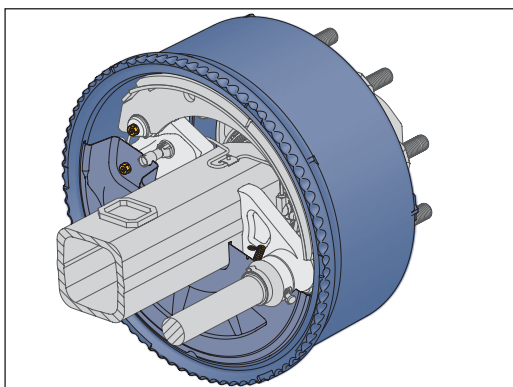

Sectional view:
New ECO Drum axle
with dust cover and former
ECO^{Plus} drum or ECO^{Plus}
brake shoes

Fig. 7: New ECO Drum axle with ECO^{Plus} brake drum and ECO^{Plus} brake shoes.



Axles (up to 9 t axle load) in the ECO^{Plus} series are being replaced by the ECO Plus 2 axle generation (see also BPW NEWS Allg 7125703e). When exchanging an ECO^{Plus} axle beam for an ECO Plus 2 axle beam, it is therefore also necessary to exchange the toothed washer with pin, the axle bolt, the clasp locking ring with retaining key and the dust covers.

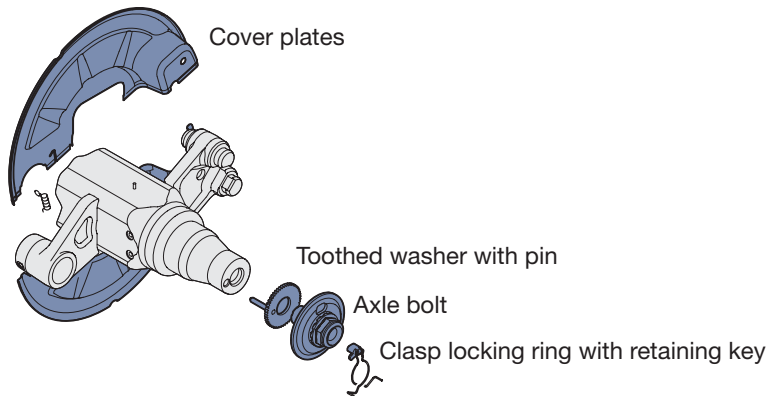

Fig. 8: ECO Plus 2 axle beam

Please note the new service and maintenance instructions when exchanging the individual components.

More information

Refer to the "Quality meets Innovation: New BPW Products 2007" booklet in this regard. The booklet is available from the Sales Department at your local BPW contact, or as a download from www.bpw.de in the section "Running gear technology for... Drawbar trailers and semitrailers". The booklet contains a comprehensive presentation of the advantages and technical features of all products. The corresponding code numbers of the new ECO Drum versions can now be obtained from your contact in the BPW Sales department.