

ECO Drum now also available for drum brake axles with SN 4220!

BPW Bergische Achsen KG has occupied a leading position in drum brake technology for many years now, and has significantly extended its lead over the competition. Customers have bought more than 11 million drum-brake axles from BPW, and they appreciate the proven technology, robust construction and straightforward maintenance of the BPW drum brake.

Following the changeover of brake size SN 4218, the weight, wear properties and service friendliness of the SN 4220 are now being improved as a second step. The result is the new ECO Drum SN 4220.

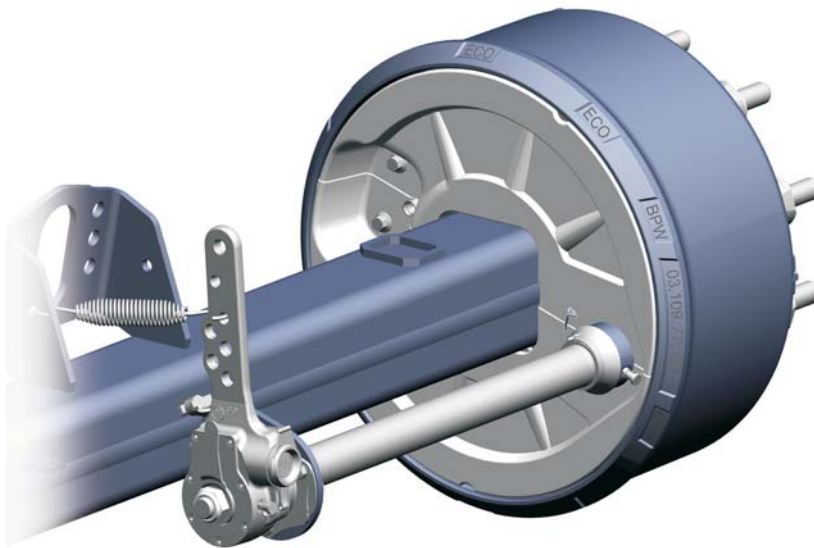

Fig. 1: BPW ECO Drum with SN 4220 brake

The most striking feature of the new ECO Drum is the patented design of the drum contour in the bead area that replaces the characteristic undulating profile of the former BPW product range. In future too, this will also offer optimum protection against pirates and therefore continue to guarantee customers unmistakably reliable BPW quality. The newly designed dust cover with integrated observation holes means that the wear edges of the brake lining and the brake drum can be checked easily.

The improved seal between the dust cover and the brake drum reduces the amount of dirt entering the brake and therefore further increases the service life of the brake components. The advantage for the user is obvious. Less complexity and therefore lower costs.



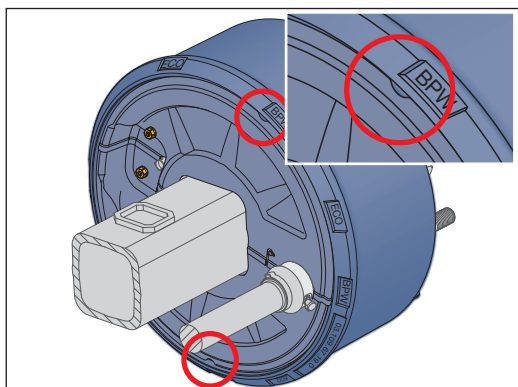

Fig. 2: ECO Drum, lining observation holes

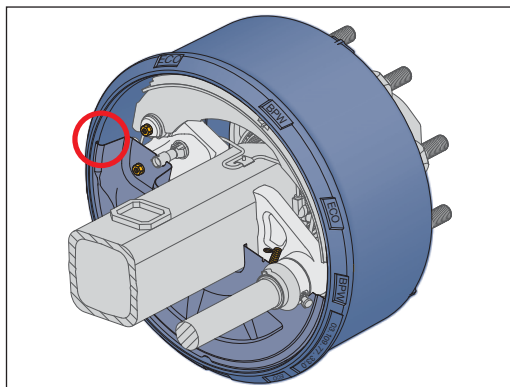

Fig. 3: ECO Drum, dust cover seal

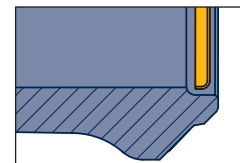

Fig. 3.1:
Sectional view,
ECO Drum axle with
new dust cover con-
tour

The quality of the dust cover attachment has been improved by using threaded bolts. This ensures that the dust cover can still be removed perfectly even after years of operation under the toughest conditions. The dust cover is quickly and easily inserted on the camshaft side and secured by a spring.

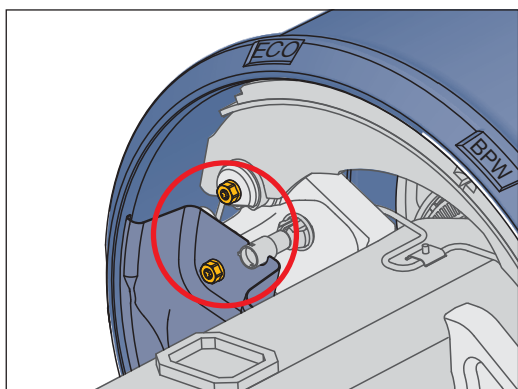

Fig. 4: ECO Drum, threaded bolts

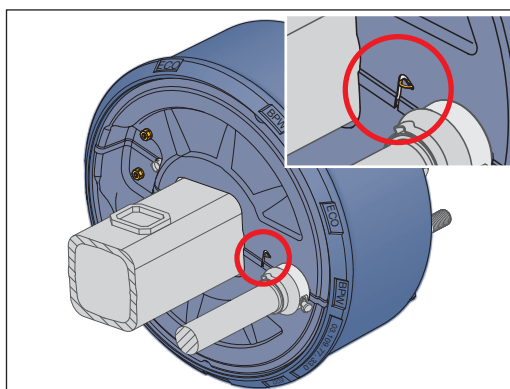

Fig. 5: ECO Drum, spring holder

The advantages of the new ECO Drum are obvious: Greater payload, less wear and even easier servicing. These factors all add up to bigger profits for our customers.

Series launch

The SN 4220 will be delivered from week 05/2008 onwards in the ECO Drum version. It replaces all existing versions of the SN 4220.

Brake certificate

No new homologations are required for ECO Drum. The updated brake certificates for the ECO Drum SN 4220 can be found in the download centre on the BPW website at www.bpw.de using the familiar TDB numbers. The BPW ECO Drum axle can be installed in a vehicle together with the former drum-brake axle.

Spare parts - compatibility

Only the new ECO Drum brake drums will be available as spares. The new brake drums can be used on the former drum-brake axles even without exchanging the dust cover.

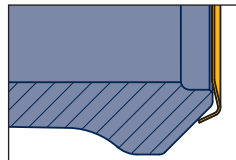
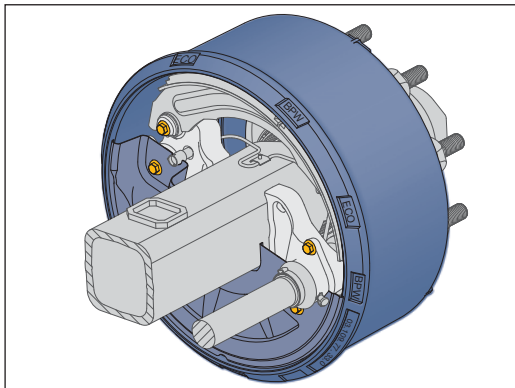

Fig. 6.1:
Sectional view,
former ECO^{Plus} axle with dust cover
and new ECO Drum.

Fig. 6: Former ECO^{Plus} axle with ECO Drum brake drum.

In addition, dust covers are available with the new external contour and the old brake anchor plate attachment. This means customers can benefit from the improved seal integrity between the new dust cover and brake drum design even when using the old type of drum-brake axles.

From September 2007 onwards, axles (up to 9 t axle load) in the ECO^{Plus} series are being replaced by the ECO Plus 2 axle generation (see also BPW NEWS Allg 7125703e). When exchanging an ECO^{Plus} axle beam for an ECO Plus 2 axle beam, it is therefore also necessary to exchange the toothed washer with pin, the axle bolt, the clasp locking ring with retaining key and the dust covers.

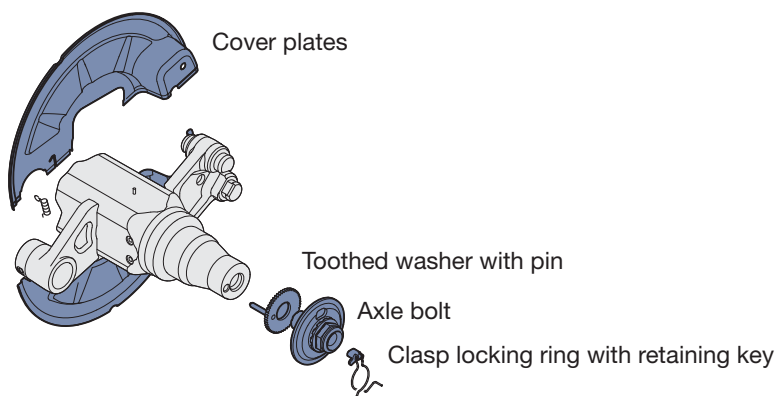

Fig. 7: ECO Plus 2 axle beam

Please note the new service and maintenance instructions when exchanging the individual components.