

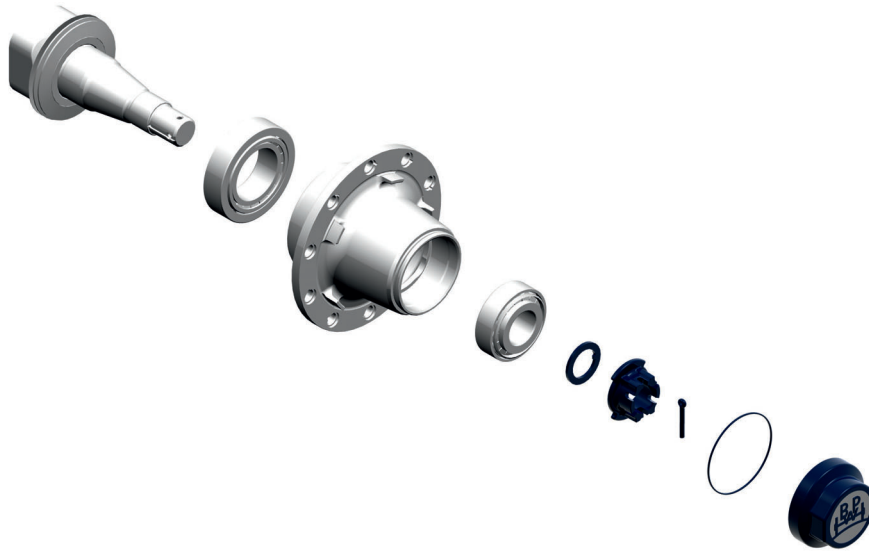

Optimization of axle bearing seats by 16 t - 18 t axles

As of November 2016 BPW introduces the improved axle bearing seats and optimized hub cap sealing at axle series H... 16010/18010.



Features and benefits:



- › Quick and easy maintenance through optimized bearing seats. Disassembly of the bearing in case of service is possible without any additional pulling device. It is no longer necessary to heat the bearings during assembly.
- › Durable design with non-rotating, hardened thrust washer
- › Improved hub cap sealing with inner thread and O-ring
- › Easy assembly thanks to a reduced tightening torque of the hub cap of 350 Nm
- › Optimized grease quantity in the hub bearing for best lubrication and durability
- › More flexibility thanks to the long wheel seat (32 mm) for other wheel rims

The versions with trilex-hub are only converted to the improved bearing seats, but not optimized hub cap sealing. For the versions with trilex hub remains the previous hub cap unchanged.

- › The revised 16 t - 18 t product range (axles and suspensions) is introduced with the new part numbers:
- › Rigid axles 30.16.... (old) => 27.16.... (new)
- › Self-steering axles 36.16.... (old) => 26.16.... (new)
- › Swing axle/ Stub axle => new part numbers
- › Suspensions => new part numbers

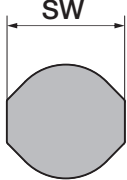

- › A new box spanner for hub caps with BPW shape and ring spanner with BPW shape are available.

	 <p>BPW-Form</p>	
<p>Box spanner (1") SW 140 03.364.29.05.0</p>		<p>Ring spanner SW 140 03.339.05.09.0</p>

- › The 03.364.25.03.0 (SW 85 with BPW shape) is available for the new axle nut.

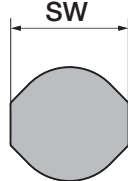
	 <p>BPW-Form</p>
--	--

- › There is a new tool kit with the part number 99.00.000.9.71 available.
- › The new axle nut with thrust washer is not substitutable with the old axle nut (castle nut).

For further information or if you have any questions please do not hesitate to contact your BPW Partner.