

3

English | Deutsch | Français | Español | Italiano | Pycckий

Home

Hilfe

ET-Stücklisten NFZ

Einzelteilsuche NFZ

ET-Stücklisten Agrar

we thin

2

English | Deutsch | Français | Español | Italiano | Pycckий

Home

Hilfe

ET-Stücklisten NFZ

Einzelteilsuche NFZ

ET-Stücklisten Agrar

we thin

ET-Stücklisten NFZ | Suchen

1

English | Deutsch | Français | Español | Italiano | Pycckий

Home

Hilfe

ET-Stücklisten NFZ

Einzelteilsuche NFZ

ET-Stücklisten Agrar

we thin

ET-Stücklisten NFZ | Suchen

Sachnummer Achstyp Herstell-Datum und Nr. Stumpfschweiß-Nr. 

+ -

Selektierte Objekte:

Ansehen

Sprache des Exports

Deutsch

Sachnummer	Benennung	Verkn. ETL
05.292.06.84.0	Pendelarmgruppe (Pos. 1300) für ..VK / VKT	-
05.292.06.85.0	Pendelarmgruppe (Pos. 1305) für ..VK / VKT	-
05.292.06.92.0	Pendelarmgruppe (Pos. 1300) für ..VKT	-
05.292.06.93.0	Pendelarmgruppe (Pos. 1305) für ..VKT	-
05.292.07.01.0	Pendelarmgruppe (Pos. 1305) für ..VB C	-
05.292.07.02.0	Pendelarmgruppe (Pos. 1300) für ..VB C	-
05.292.07.05.0	Pendelarmgruppe (Pos. 1305) für ..VB C	-
05.292.07.06.0	Pendelarmgruppe (Pos. 1300) für ..VB C	-

**My BPW –**  
 spare parts are just a click  
 away.

we think transport



# Looking for a spare part?

we think transport



Do you have a **My BPW log-in**?

Yes

No

... Then we wish you safe onward travels with tried-and-tested BPW quality!

Do you have the **code number for the spare part** you are looking for?

Of course!

Not yet

...register at [www.bpw.de/mybpw](http://www.bpw.de/mybpw)

Sorry, pardon?

You will find the **axle code number** of the spare part you are looking for on the axle type plate.

Yes, I have it here

**Identify** the spare part you require by looking at the **exploded-view drawing** and selecting it from the spare parts list.

Make a note of the code numbers of your required spare parts on your **order list** and send it to your **BPW contact by email or fax.**

Alles klar  
capito.  
Bien, alors!  
Alright  
Ясно! Si, claro

# Target the right item from more than 10,000 BPW original spare parts.

Durable, maintenance-free products are a prerequisite for the efficient operation of your trailer and a central part of our commitment as a systems and international mobility partner. For us, however, there is more to it than that: within the framework of regular, pro-active maintenance, and of course in cases of emergency, you can rely on our supply of original quality spare parts – worldwide. To speed up the ordering process, My BPW helps you to quickly identify the parts you need. Over the next few pages, we want to show you how easy this is.

## 2. Navigation on My BPW

You will find the multilingual spare parts search function in the navigation column under the headings Commercial vehicles parts lists, Commercial vehicle spare parts search, and Agricultural vehicles parts lists. We will give you user-specific access to these areas, as well as to the technical data sheets. In addition to the spare parts search function, My BPW also offers model test reports for download.

MY BPW - NAVIGATION
▼ Home
▶ Wallpaper
▶ Newsletter
▶ Model test report
▶ Datasheets
▶ Spare parts - commercial vehicles parts lists
▶ Commercial vehicle spare parts search
▶ Spare parts - agricultural vehicles parts lists
▶ My settings
▶ Logout

## 3. Spare parts search function

Each BPW original spare part's 10-digit stock code serves as the basis for the search. This code number can be found on the axle type plate which should be entered into the appropriate search field. You can enter the number with punctuation (e.g. 27.58.617.001), without punctuation (e.g. 2758617001), or with placeholders (e.g. 275861\* or 27.\*61.0\* to display multiple BPW spare parts in tabular form).

As well as allowing you to search for individual BPW parts, My BPW also enables the display of additional information and the printing of PDF documents. If you click on the "+" button in the search field, any auxiliary parts related to the listed BPW items will also be displayed. Click on "-" to close the display again.

Code number	27.58.617.001
Axle type	
Date of manuf. and no.	
Butt welding no.	

If you have any problems with the search, you can follow the search process step-by-step by clicking on the "Help" icon in the top left-hand side of the page.

## 4. Search results

When the spare parts list is displayed in the form of search results, you can open each part's material master display by clicking on it. This includes dimensions, item number, and other information, such as the number of parts you will need to effect a repair. In addition, a movable window will also display an image of the item, as well as a table listing auxiliary parts.

If one or more groups are displayed, click on each group to open a list of all the parts contained and a corresponding exploded-view drawing (click to enlarge). Click again on any spare part on this list to open the material master display.

Code number	Name	Linked SPL	Selection
27.58.612.000	BPW Trailer Axle SKHBF 9010 ECO Plus 2	4	<input type="checkbox"/>
27.58.612.001	BPW Trailer Axle SKHBF 9010 ECO Plus 2	4	<input checked="" type="checkbox"/>
27.58.612.002	BPW Trailer Axle SKHSF 9010 ECO Plus 2	2	<input type="checkbox"/>
27.58.612.003	BPW Trailer Axle SKHSF 9010 ECO Plus 2	2	<input type="checkbox"/>
27.58.612.004	BPW Trailer Axle SKHSF 9010 ECO Plus 2	2	<input type="checkbox"/>
27.58.612.005	BPW Trailer Axle SKHSF 9010 ECO Plus 2	2	<input type="checkbox"/>
27.58.612.006	BPW Trailer Axle SKHBF 9010 ECO Plus 2	2	<input type="checkbox"/>
27.58.612.007	BPW Trailer Axle SKHSF 9010 ECO Plus 2	2	<input type="checkbox"/>
27.58.612.009	BPW Trailer Axle SKHBF 9010 ECO Plus 2	2	<input type="checkbox"/>
27.58.612.010	BPW Trailer Axle SKHSF 9010 ECO Plus 2	2	<input type="checkbox"/>
27.58.612.011	BPW Trailer Axle SKHBF 9010 ECO Plus 2	2	<input type="checkbox"/>
27.58.612.012	BPW Trailer Axle SKHBF 9010 ECO Plus 2	4	<input type="checkbox"/>
27.58.612.013	BPW Trailer Axle SKHBF 9010 ECO Plus 2	4	<input type="checkbox"/>
27.58.612.014	BPW Trailer Axle SKHBF 9010 ECO Plus 2	4	<input type="checkbox"/>
27.58.612.015	BPW Trailer Axle SKHBF 9010 ECO Plus 2	4	<input type="checkbox"/>
27.58.612.016	BPW Trailer Axle SKHBF 9010 ECO Plus 2	4	<input type="checkbox"/>
27.58.612.017	BPW Trailer Axle SKHBF 9010 ECO Plus 2	4	<input type="checkbox"/>
27.58.612.018	BPW Trailer Axle SKHBF 9010 ECO Plus 2	4	<input type="checkbox"/>
27.58.612.019	BPW Trailer Axle SKHBF 9010 ECO Plus 2	4	<input type="checkbox"/>
27.58.612.020	BPW Trailer Axle SKHBF 9010 ECO Plus 2	4	<input type="checkbox"/>
27.58.612.021	BPW Trailer Axle SKHBF 9010 ECO Plus 2	4	<input type="checkbox"/>
27.58.612.022	BPW Trailer Axle SKHSM 9010 ECO Plus 2	2	<input type="checkbox"/>
27.58.612.023	BPW Trailer Axle SKHSM 9010 ECO Plus 2	2	<input type="checkbox"/>
27.58.612.024	BPW Trailer Axle SKHBF 9010 ECO Plus 2	4	<input type="checkbox"/>
27.58.612.025	BPW Trailer Axle SKHBF 9010 ECO Plus 2	4	<input type="checkbox"/>

## 5. Identification

Through graphic illustrations of spare parts and exploded-view drawings of entire groups of parts, you can now identify the part you require. You can enlarge the images by clicking on them, thus enabling you to read code numbers or make exact comparisons.

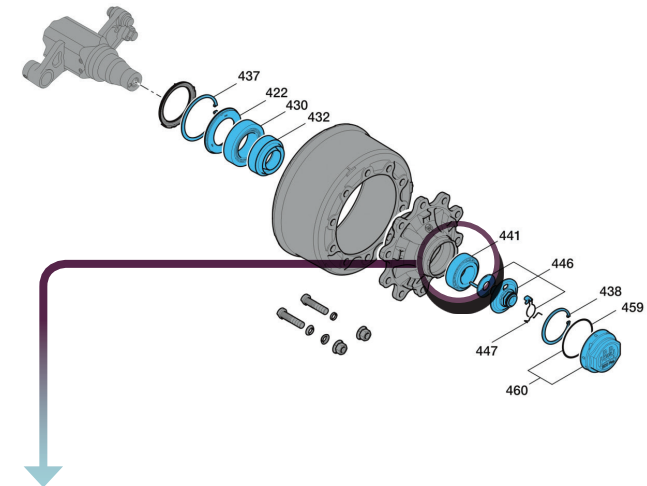

<b>02.6410.22.00 Roller bearing</b>		
Dimension: 33213		
Item	441	
Weight per piece (kg)	2,05	
Material	Steel	

## 6. Ordering

Once you have identified the part you need, you can enter the corresponding code number in your order list and send it to your BPW contact by email or fax.

## 1. Welcome to My BPW

My BPW enables you to identify spare parts quickly thanks to its well-structured content, easy-to-understand navigation with intuitive operation, and logical layout of the product ranges. Thanks to constantly updated data, 24-hour availability and the option to download parts lists which currently detail 220,000 spare parts, My BPW also facilitates and optimises the flow of your spare parts ordering. Before you can start your search, you must register with My BPW. We will send you a link by email, which you click on to confirm receipt and receive your personal access details.

The brands of the BPW Group:



My BPW Flyer 16481501 e  
www.united.de

**we think transport**

## BPW Bergische Achsen Kommanditgesellschaft

Postbox 12 80 · 51656 Wiehl, Germany

Telephone +49 (0) 2262 78-0 · info@bpw.de

[www.bpw.de](http://www.bpw.de) | [www.wethinktransport.com](http://www.wethinktransport.com)

**we think transport**

